

The murderer has been caught!

Here's where every  
everyone was.

1. B is in the Arboretum, G must be in the Bonsai Exhibit, H in the Resting Area, then D must be alone in the Flower Garden. So the only room where F and I can be alone are the Info Desk and the Gazebo.

2. Who can E be alone with, while also sitting in a chair? The only possibility is G, in the Bonsai Exhibit. E is in C1, this isolates I in the R1C8 chair, which isolates E.

3. This isolates F in the Gazebo, then D must be in C3. This isolates G.

4. This isolates K.

5. This also isolates B in the last chair in the Arboretum

6. This isolates C in the last square beside a table, then J beside the last lily pad.

7. A must be in the last R5 square and then D in R6, this isolates both.

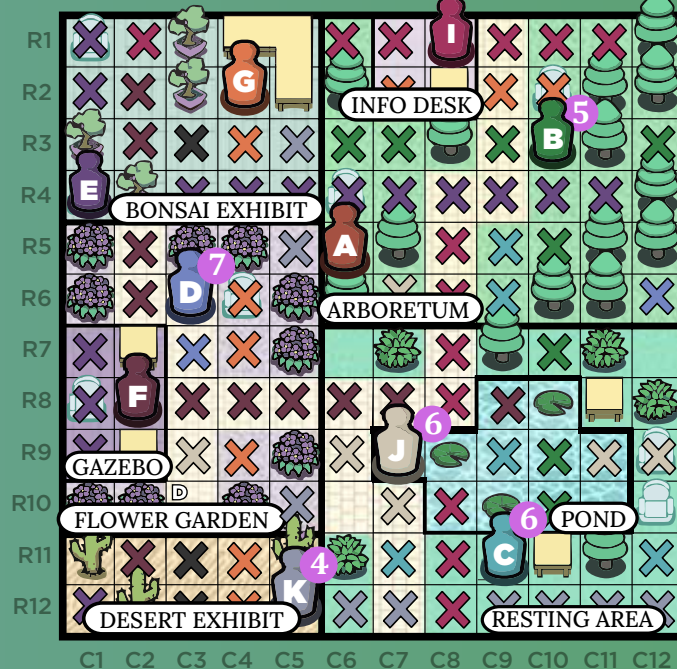
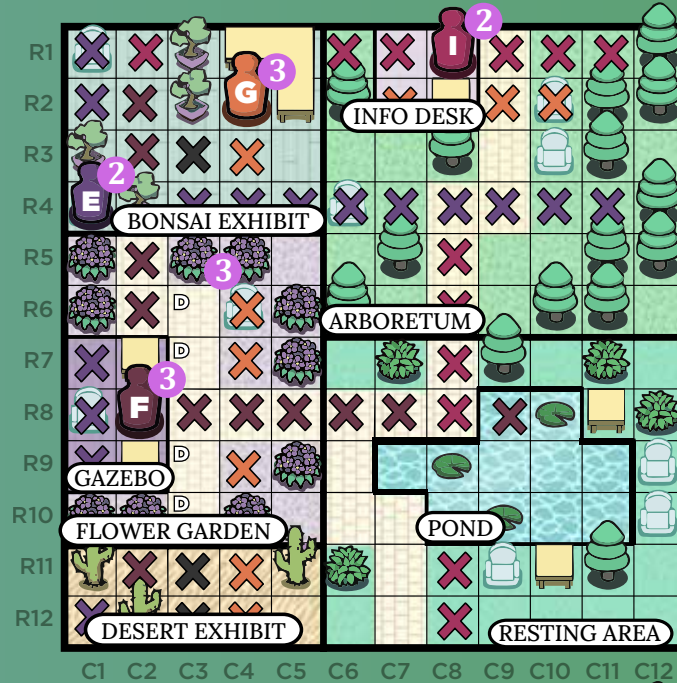

8. This isolates H in the last square beside a shrub.  
9. This isolates V in the last square, in the Pond alone with J. Joss is the murderer!

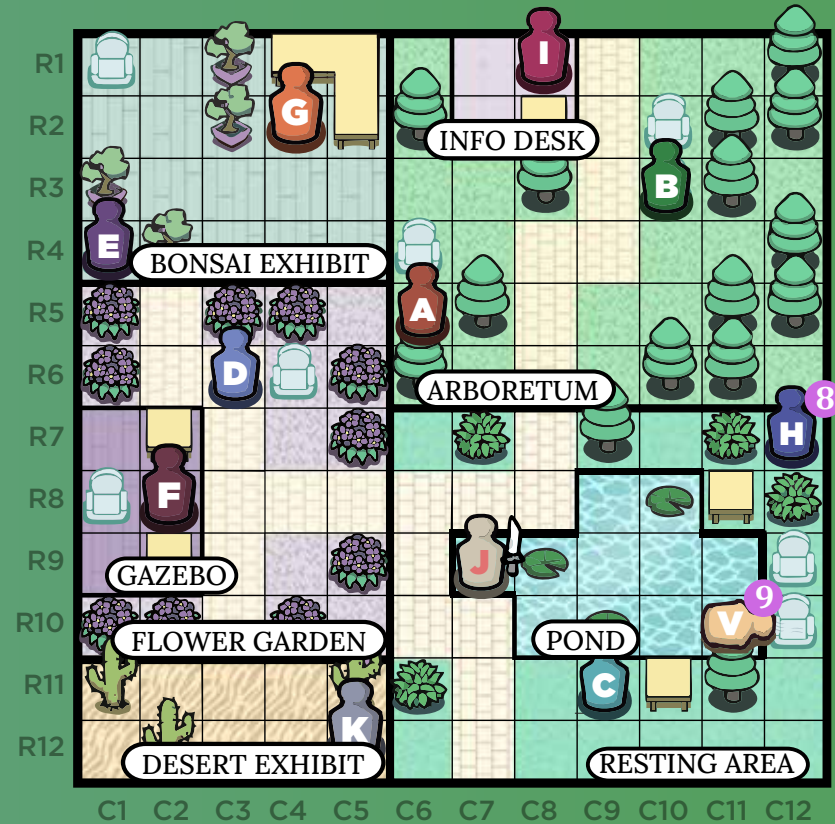

The murderer is...

*Joss*

GET THE  
BOOK NOW!



more at  
[murdoku.com](http://murdoku.com)  
puzzle and concept  
by Manuel Garand,  
art by Manuel Garand  
and Valentyna Bezдушna